



**UP TO 700,000 SF UNDERWAY  
IN CLAYTON COUNTY - UP TO  
320,000 SF AVAILABLE**

STATE-OF-THE-ART, LAST MILE INDUSTRIAL  
PARK OFFERING 5 BUILDINGS ADJACENT TO  
ATLANTA AIRPORT AT I-285 & CONLEY RD

**Building 100**

3996 Gilbert Road Atlanta, GA 30354

**Building 500**

3968 Gilbert Road Atlanta, GA 30354



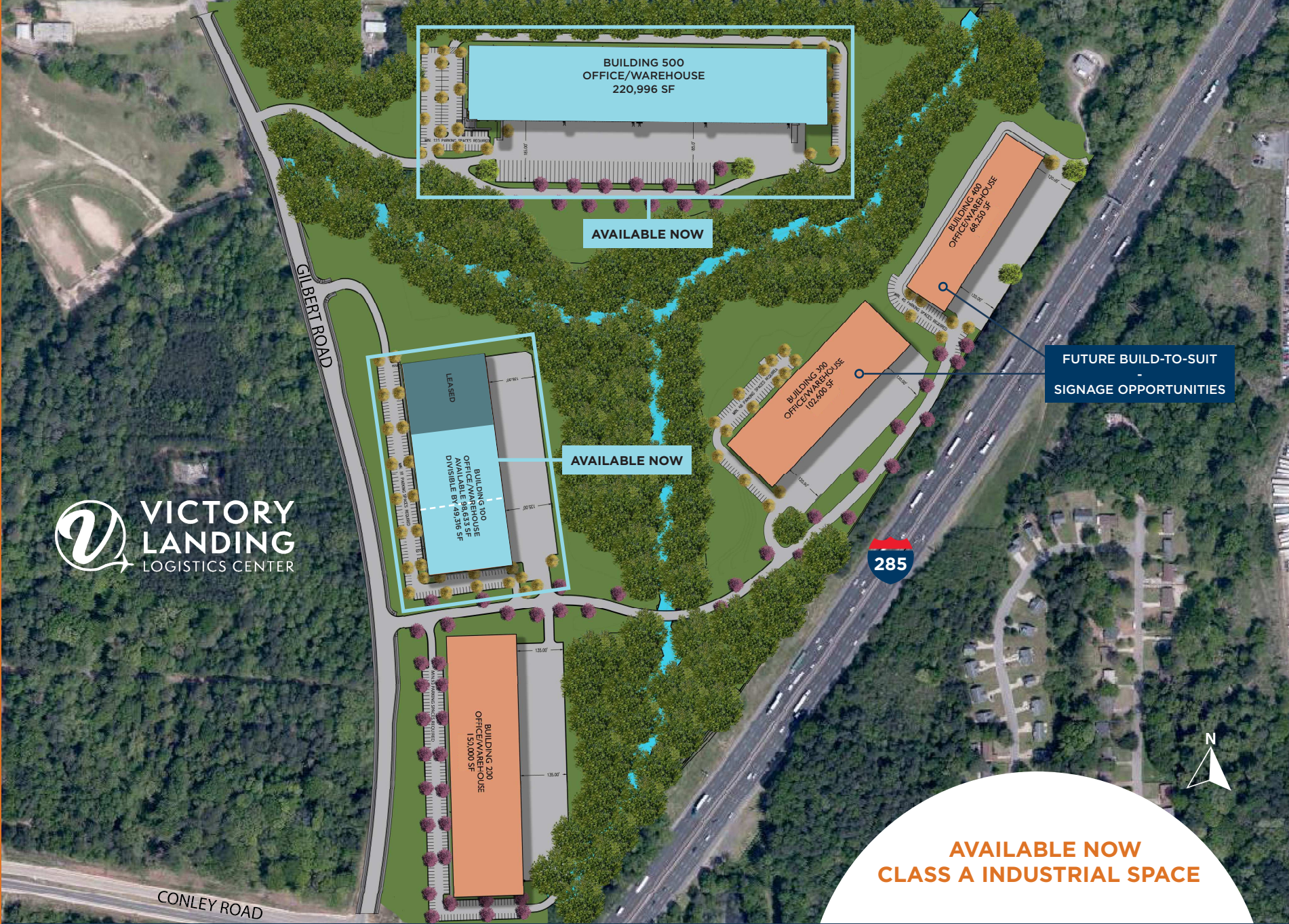

Phase 1	
<b>Building 500</b> ±220,996 SF	<b>Building 100</b> 98,633 SF Available

<b>Coming Soon</b> <b>Building 200</b> ±150,000 SF
--

**AVAILABLE NOW**  
**CLASS A INDUSTRIAL SPACE**

**±90 Acre**  
Development

**32'**  
Clear Heights

**Premiere Infill Location**  
in Park Setting

**±688,206 SF**  
Total SF Available

**Maximum Exposure**  
with I-285 frontage



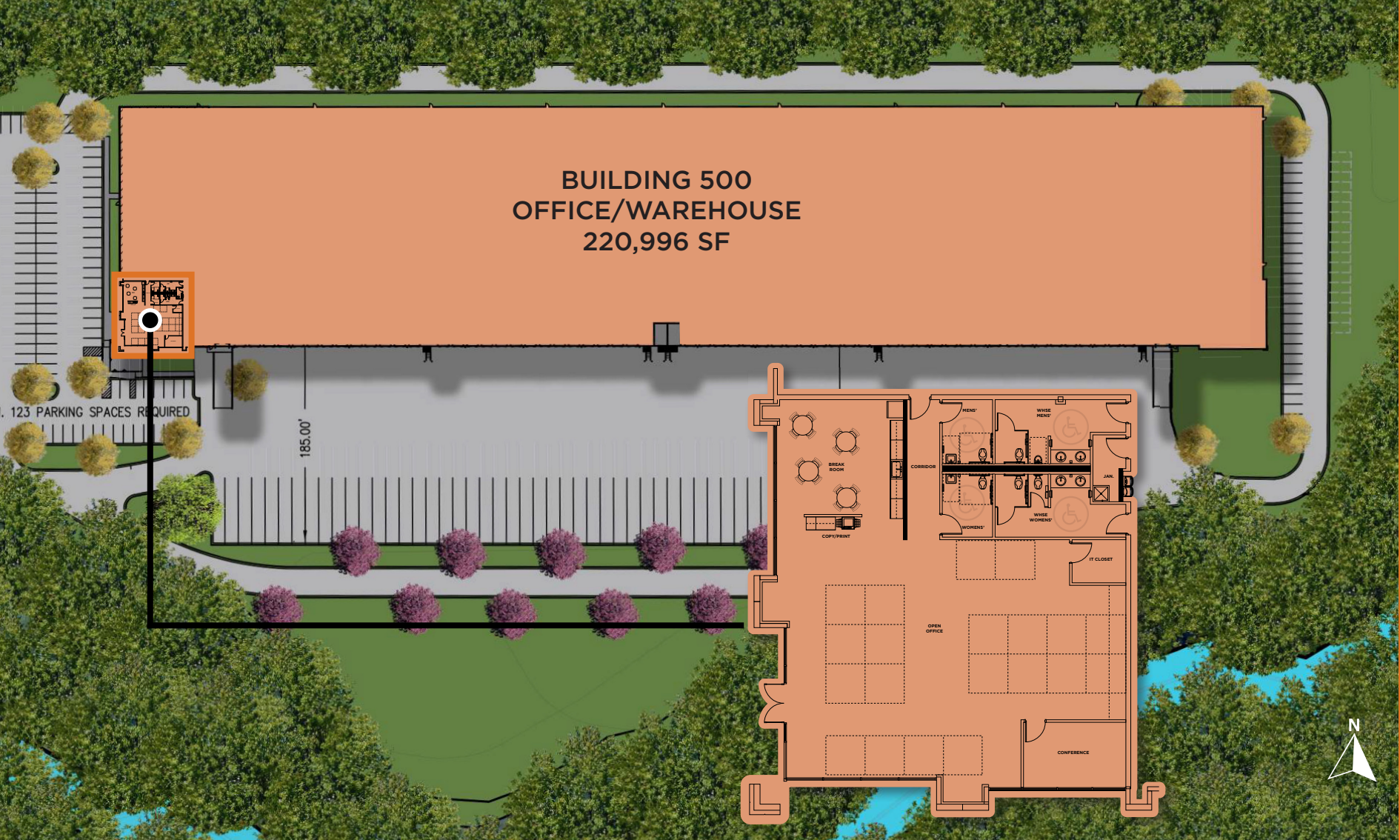

## **BUILDING 500** | 3968 GILBERT RD.

### **Property Specs**

- Total Building Size: ±220,996 SF
- Total Space Available: ±220,996 SF
- Building Dimensions: 215' x 1024'
- Office Space: ±3,231 SF
- Clear Height: 32'
- Dock High Doors: 58
- Drive-in Doors: 2
- Truck Court Depth: 185'/125'
- Auto Parking: 150
- Trailer Parking: 52
- Column Spacing: 52' x 51'8"
- Configuration: Front Load
- Lighting: LED
- Sprinkler System: ESFR
- Construction: Precast Concrete



## **BUILDING 100** | 3996 GILBERT RD.

### **Property Specs**

- Total Building Size: 147,382 SF
- Available: 98,633 SF
- Building Dimensions: 240' x 610'
- Office Space: ±2,774 SF
- Clear Height: 32'
- Dock High Doors: 24
- Drive-in Doors: 1
- Truck Court Depth: 135'
- Auto Parking: 117
- Trailer Parking: 5
- Column Spacing: 52' x 45'
- Configuration: Rear Loaded
- Lighting: LED
- Sprinkler System: ESFR
- Construction: Precast Concrete





**DOWNTOWN  
ATLANTA**



**ATLANTA INTERNATIONAL  
AIRPORT**



**VICTORY  
LANDING**  
LOGISTICS CENTER

**LAND YOUR BUSINESS IN  
A ONE-OF-A-KIND CLAYTON  
COUNTY LOCATION!**

**\$40M OF ROAD  
IMPROVEMENTS RECENTLY  
COMPLETED TO GILBERT RD.**



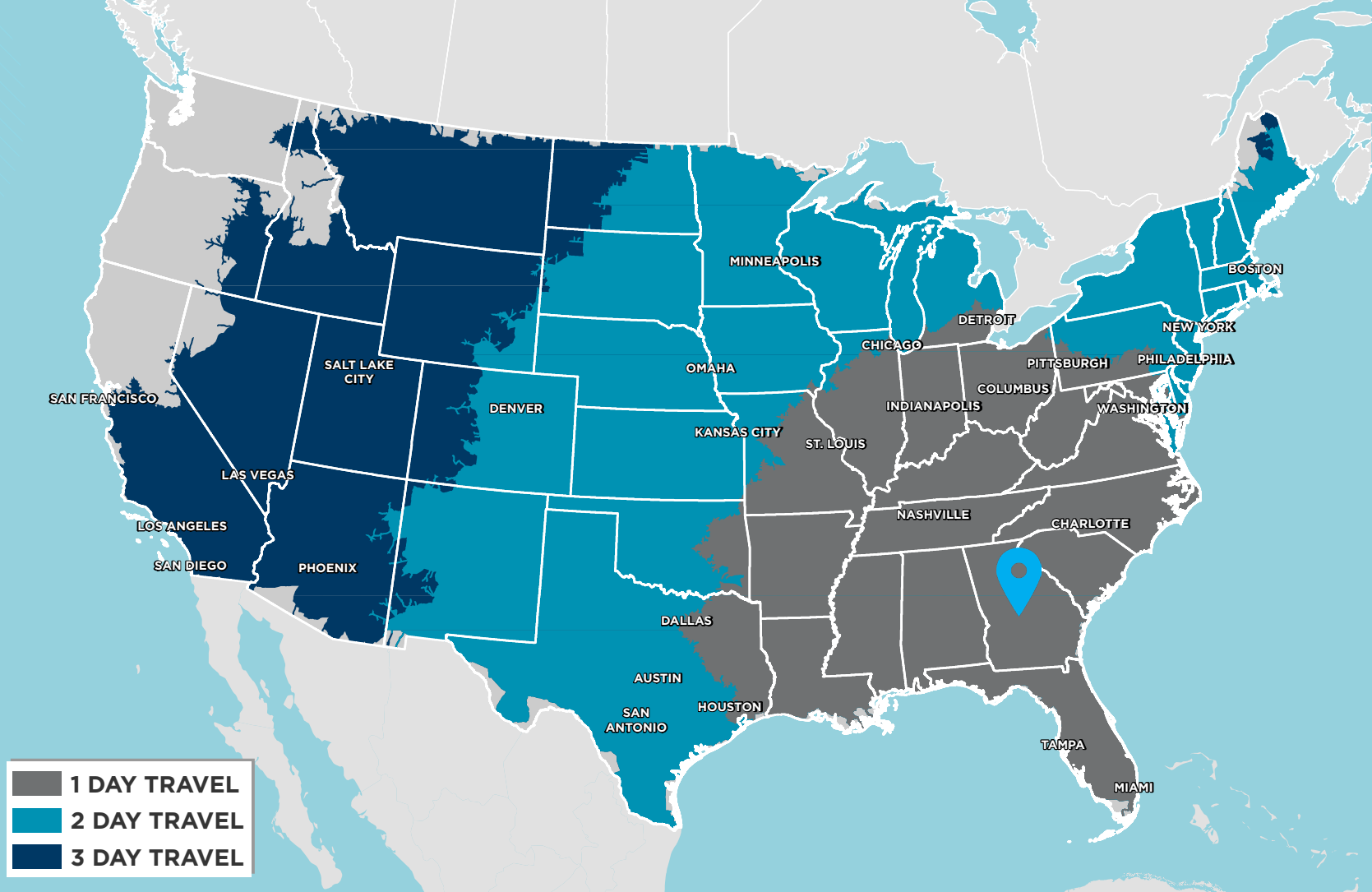

Prime opportunity for last mile, eCommerce, 3PL, and food & beverage users with immediate access to Atlanta International Airport and full I-285 and I-75 interchanges.



**1.2 Miles**  
to I-285



**1.5 Miles**  
to I-75



**2 Miles**  
to Atlanta  
International  
Airport



**10 Miles**  
to CSX  
Intermodal



**14.5 Miles**  
to Norfolk  
Southern  
Intermodal



**242 Miles**  
to Port of  
Savannah



**300 Miles**  
to Port of  
Charleston



## POTENTIAL TAX SAVINGS

# of Jobs	Tax Credit per Job	Annual Savings	5 Yr. Cumulative Savings	SF Savings on 100,000 SF
100	\$4,000	\$400,000	\$2,000,000	\$4.00/SF
200	\$4,000	\$800,000	\$4,000,000	\$8.00/SF
300	\$4,000	\$1,200,000	\$6,000,000	\$12.00/SF
400	\$4,000	\$1,600,000	\$8,000,000	\$16.00/SF

## WHERE BUSINESS TAKES OFF

### JOB TAX CREDITS

Situated within a Tier 1 Less Developed Census Tract (LDCT), Victory Landing Logistics Center users will be eligible for annual job tax credits of \$4,000 per new employee for up to 5 years (for a total of \$20,000 per job created). Businesses receiving the job tax credit can apply it to 100% of their tax liability each year and credits may be carried forward for up to 10 years.





Pat Murphy  
Managing Director  
+1 404 682 3405  
[pat.murphy@cushwake.com](mailto:pat.murphy@cushwake.com)

Lisa B. Pittman, SIOR  
Executive Director  
+1 404 309 5309  
[lisa.pittman@cushwake.com](mailto:lisa.pittman@cushwake.com)

Andrew Thurman  
Senior Associate  
+1 404 682 3429  
[andrew.thurman@cushwake.com](mailto:andrew.thurman@cushwake.com)



©2022 Cushman & Wakefield. All rights reserved. The information contained in this communication is strictly confidential. This information has been obtained from sources believed to be reliable but has not been verified. NO WARRANTY OR REPRESENTATION, EXPRESS OR IMPLIED, IS MADE AS TO THE CONDITION OF THE PROPERTY (OR PROPERTIES) REFERENCED HEREIN OR AS TO THE ACCURACY OR COMPLETENESS OF THE INFORMATION CONTAINED HEREIN, AND SAME IS SUBMITTED SUBJECT TO ERRORS, OMISSIONS, CHANGE OF PRICE, RENTAL OR OTHER CONDITIONS, WITHDRAWAL WITHOUT NOTICE, AND TO ANY SPECIAL LISTING CONDITIONS IMPOSED BY THE PROPERTY OWNER(S). ANY PROJECTIONS, OPINIONS OR ESTIMATES ARE SUBJECT TO UNCERTAINTY AND DO NOT SIGNIFY CURRENT OR FUTURE PROPERTY PERFORMANCE.